

Stainless steel Lumiglas luminaire series ME

DATA SHEET 06.02.02

- **Sturdy, attractively shaped, registered design-protected.**
- **For use with screwed sight glass fittings.**
Providing combined sight and light port, suitable for circular screwed sight glass fittings to DIN 11851 or similar dairy style, sizes DN 65 to DN 125.
- **Application:**
Designed for use in **pharmaceutical and food processing industries** e.g. breweries, dairies etc. for illumination of internals of tanks, reactors, mixers, separators and other normally closed vessels as well as pipelines in **non explosion hazardous areas**.
- **Protection:**
When correctly fitted, dust and waterspray tight IP65 to EN 60 529/ DIN VDE 0470 part 1.
- **Operating conditions:**
Independent of vessel pressure/vacuum; max. permissible ambient temperature at the cable gland 80° C.
- **Electrical data:**
Feed voltage: 24 V (12 V available as alternative)
Lamp: 2 pin Halogen filament lamp.
Depending on model, 20 W or 50 W.
- **Lamp holder:**
2 pin socket.
- **Transformer:**
Available as special accessory.
- **Integral switch:**
The luminaries are fitted with non maintained push button switch as standard.
- **Supply cable:**
Temperature resistant supply cable – 3 m length – will have been works fitted (Lapptherm 105 up to 90° C). Lumistar ME is ready wired internally.



Stainless steel Lumiglas luminaire series Lumistar ME.

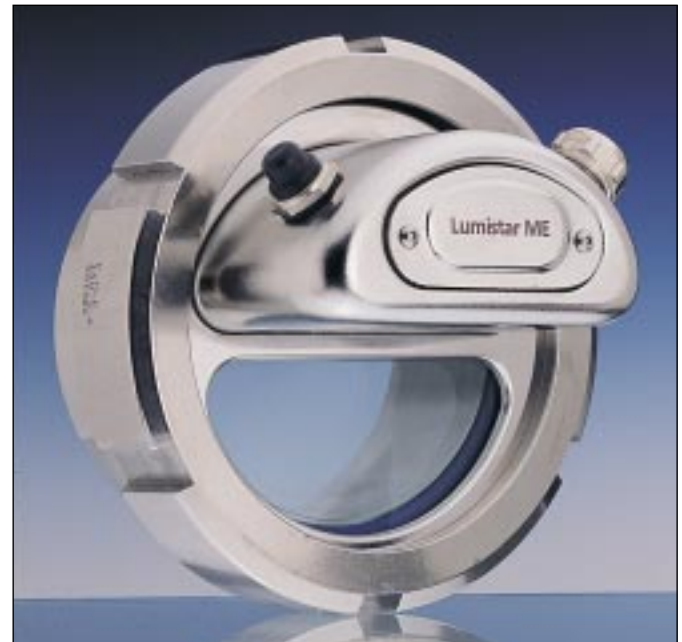

Stainless steel Lumiglas luminaire series Lumistar ME combined with screwed sightglass.

• Dimensions and connecting data for Stainless steel Lumiglas luminaires series ME

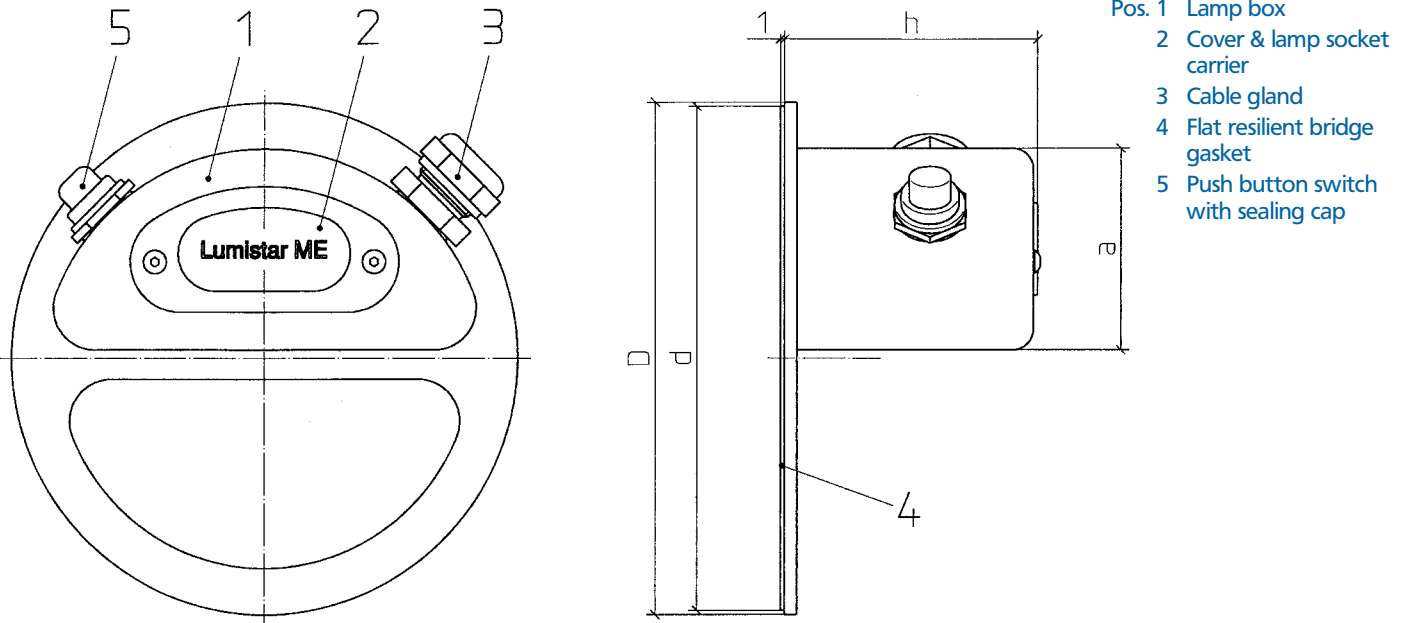

- Pos. 1 Lamp box
- 2 Cover & lamp socket carrier
- 3 Cable gland
- 4 Flat resilient bridge gasket
- 5 Push button switch with sealing cap

• Parts, materials and assembly:

- Luminaire body stainless steel 1.4301.
- Satin surface finish for pharmaceutical and food processing.
- Lamp box lid (2) fitted with resilient flat gasket, exposes lamp socket for easy access and screws onto lamp box (1).
- Non maintained push button switch (5) with separate sealing cap fitted as standard.
- Connection of cable through gland (3) to internal terminals 2.5 mm².
- Supply cable; 3 m cable tail works fitted and ready wired internally (Lapptherm 105 up to 90° C).

Size		1	2	3	4
Lumiglas-Luminaire	Type	ME 65	ME 80	ME 100	ME 125
Compatible with screwed sightglass fittings to DIN 11851 or similar	DN	65	80	100	125
Voltage (optional)	V	24	24	24	24
Wattage	W	20	20	50	50
Dimensions	D	89	102	122	152
	d	86	99	119	149
	a	35	35	48	48
	h	45	45	60	60
Weight appx. and excl. cable	kg	0,115	0,140	0,330	0,345

Combination with Lumiglas wiper SW1: Lumistar luminaire size ME 125 can be combines with wiper SW1.

• Ordering Specification: Example: Lumiglas luminaire ME 100/24 V – 50W.

• Important when ordering:

Where the Lumistar ME unit is to be fitted into an existing screwed sight glass, the slotted cover nut must be suitably modified to take the luminaire flange or a matching cover nut ordered – please see bore dimensions 'd8' contained in DIN 11851. If in doubt please ask supplier.

All dimensions in mm unless stated otherwise. Subject to change without prior notice.RD
RD 2x1000/12.01 3755.192